



Elmazoor Steel

Elmazoor Steel Company is Considered One Of The Largest Companies Working in The Field Of Colored & Galvanized Sheet & Hot Sheet & Cold Sheet in Egypt.

Which was Established in The Year 1952

Elmazoor Steel Introduce a new high Quality Products in The Field Of

(Construction Supplies , Cold Storage industry , Insulation Products)

More than **70** years
of experience





CONTENTS

3	WHO ARE WE
5	CARAVANS
25	HINGED DOORS

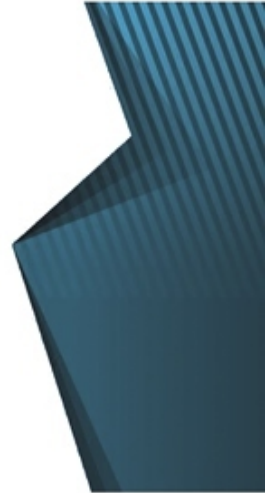

Who Are We

ELMAZoor STEEL is one of the biggest names in Egypt in the field of colorful sheet , galvanized sheet , hot and cold sheet , sandwich panels , caravans , cold storage , construction supplies , making and forming steel pipes.

The company was established in **1952** , more than **70 years ago** , providing it with the edge amongst other competitors in the same field , its distinguished reputation is aided by its cooperation with world class companies in the market and adhering to the global standards of quality and safety.

ELMAZoor STEEL acts as an agent for a lot of providers and suppliers of raw materials , with a big advantage that the company also manufactures and reshapes said materials into multiple products according to the needs of the egyptian market using the latest and the cutting-edge technologies in their production lines and factories.

Other advantage of the company's practice is the accuracy and the speed in handling the customer's orders, this is gained through long years of experience in dealing with entities from both public and private sectors
The company's pricing policy is unmatched amongst its competitors , this combined with other facilities and features makes.

ELMAZoor STEEL one of the most advanced firms in the field of steel manufacturing and give it the edge within the field.

Finally, we at **ELMAZoor STEEL** say it with confidence, we are ready to satisfy the needs of our clients in the most efficient manner, with the best quality, the targeted deadline and the best results overall.

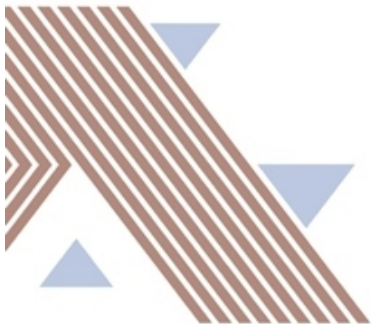

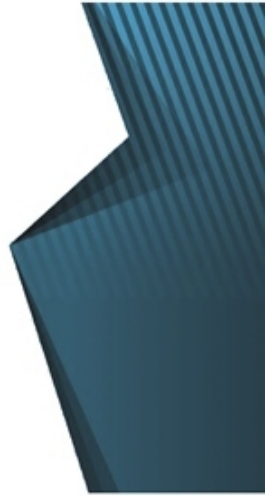

CARAVANS





Prefabricated Buildings

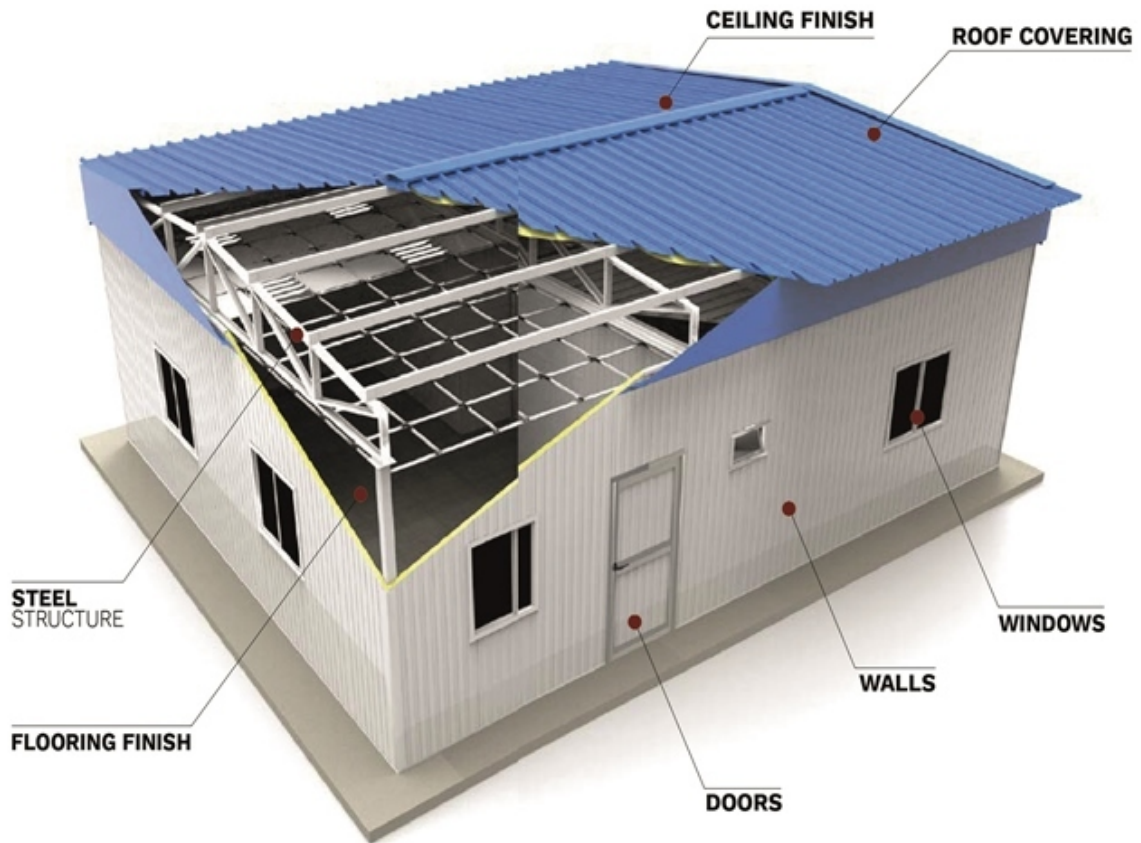



STANDARD CARAVANS







CARAVANS



TECHNICAL SPECIFICATIONS

Elmazoor Steel is considered the market leader of portable caravan units in Egypt with annual production capacity of 150 units per month .

Different designs , finishes , shapes and sizes of caravans are produced according to elmazoor steel standard or customized to suit all needs.

The standard caravan is a modular system using the 3 m width module X (3.0/4.0/5.0/6.0/7.0 8.0/9.0/10.0/11.0/12.0) m long & with internal clear height 2.30 m ,To create different and variable types of caravans to suit all requirements and function, each type can include mix of different options and utilities, we have more Than 30 designs with different specifications as follow :



01 SKELETON STRUCTURE

Hot rolled or cold formed steel sections (grade 37)

for light steel structure according to design

All steel members are corrosion treated primed & painted

fabricated according to design calculations to fit with the caravan area and function

02 ROOF

Corrugated galvanized steel sheets G60 per - panted with polyester paint fixed using self drilling screws and fitted with the necessary flashing and trims over a heat insulation layer of glass wool blanket and density 16Kg/m³ or even we can use ECO panels or standard sandwich panels





03 CEILING

Decorative colored metallic strips
25CM, Elmazoor Steel standrad
Or Gypsum tiles 60cm × 60cm

04 WALLS

External walls & internal partitions
of standard wall sandwich panels
4CM up to 8CM
also we can use gypsum board
lining wall covering to get the
internal painting finish if required



05 DOORS

single or double leaf hinged door filled
with sandwich panel or milamin size
(0.7-0.8-0.9) m × 2.00m
with silver anodized Aluminum frame
sections including its accessories or
can be wood or steel doors

06 WINDOWS

Sliding windows PVC or Aluminum sections
1.00× 1.18 M,with tranparent glass
5mm & fly screen
and pivoted window 0.60 × 0.40 m
with transparent glass 5mm & fly screen
for wet areas



CARAVANS

07 FLOORING

Different types of Flooring systems can be used to suit all requirements, HDF sheets vinyl wraps installed over decking of MDF or Plywood surface, checker Plates ceramic tiles installed over metal steel dicking 0.7mm or raised floor over decking of metal steel sheets 3mm

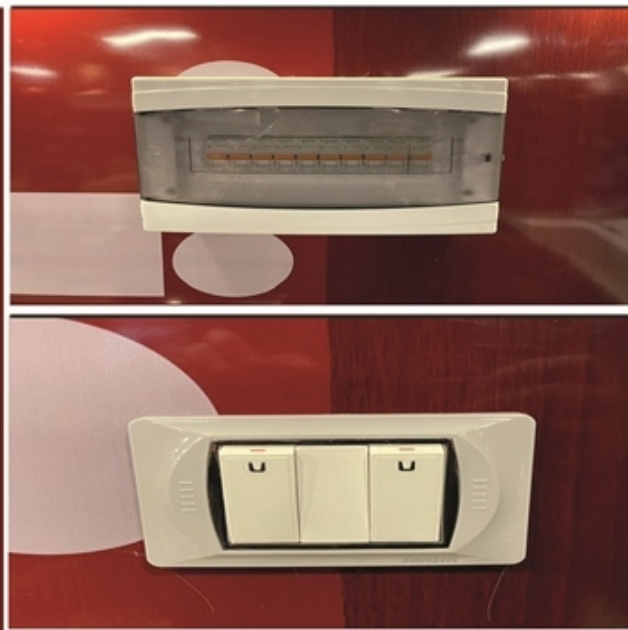

08 ELECTRICAL WORKS

Following items are installed including required wiring/Conduits

Flush mounted lighting Fixture with plastic cover and 2 Fluorescent lamps 120cm

weather proof incandescent lamp - for wet areas lighting and corridors.

Electricity outlet, 16A / 16A2P +E

Electricity Switch , 16A

AC/ Heater Switch, 26A/32A

Suitable electrical distribution panel for the above loads all wires are gathered in Flexible tubes embedded inside wall panels or can be external in PVC duct if required

09 WET AREAS

Sanitary sets including hand wash lavatory water closet , path tray , urinals and water mixers to be installed including the required feeding & drainage Plumbing works inside the caravan unite only





CEILING FINISH



PREFABRICATED BUILDINGS



WALLS



DOORS



WINDOWS



ELECTRICAL WORKS



PREFABRICATED BUILDINGS



SANITARY WORKS



FLOORING FINISH



PREFABRICATED SOCIAL FACILITIES



Prefabricated buildings are designed to satisfy several needs like

PREFABRICATED OFFICES



PREFABRICATED HOUSES



And
PREFABRICATED SCHOOLS
PREFABRICATED WORKSITE BUILDING





STANDARD MODULAR CARAVAN

The standard caravan is a modular system using the 3 m width module × (3.0m / 4.0m / 5.0m / 6.0m / 7.0m / 8.0m / 9.0m / 10.0m / 11.0m / 12.0m)

Long & with internal clear height 2.30 m , to create different and variable types of caravans to suit all requirements and functions , each type can include mix of different options and utilities.

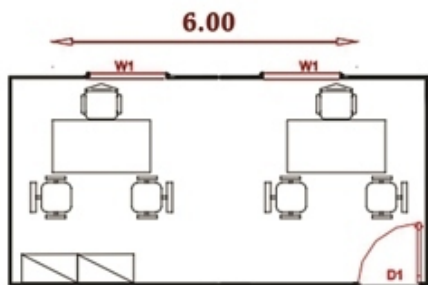

3x6 m Caravan - One Room



Front View

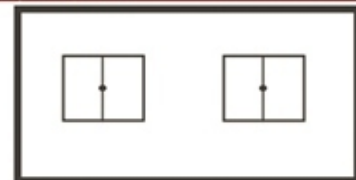

Back View

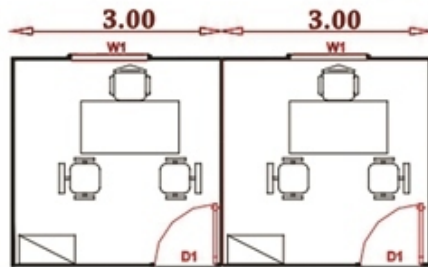

3x6 m Caravan - Two Rooms



Front View

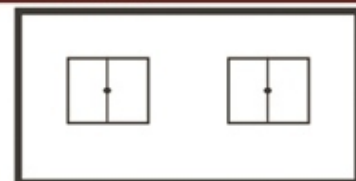

Back View

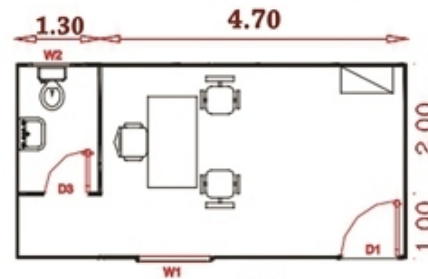

3x6 m Caravan - One Rooms & Bathroom

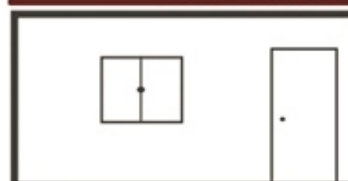

Front View

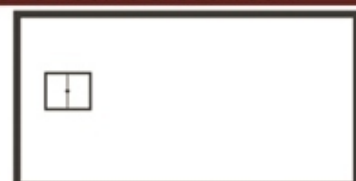

Back View

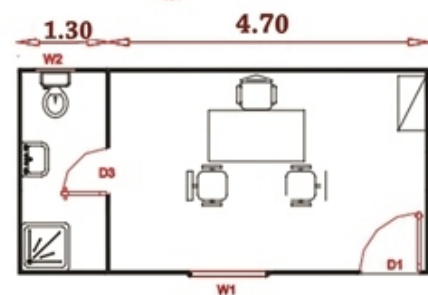

3x6 m Caravan - One Rooms & Bathroom

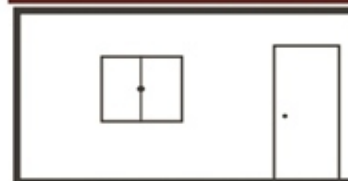

Front View

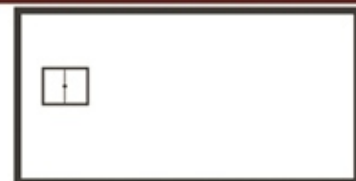

Back View



STANDARD MODULAR CARAVAN

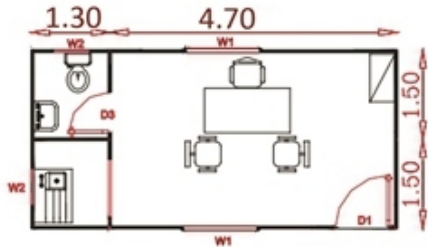

3x6m Caravan - one room , bathroom & kitchen

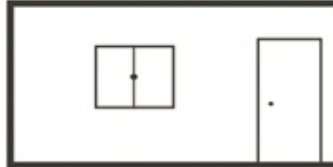

Front View

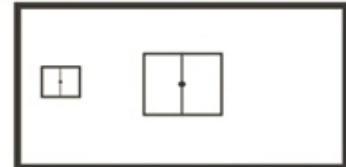

Back View

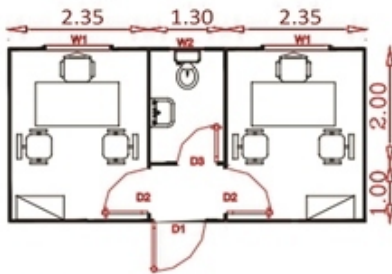

3x6m Caravan - two room & bathroom

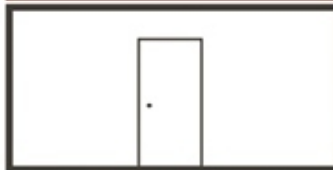

Front View

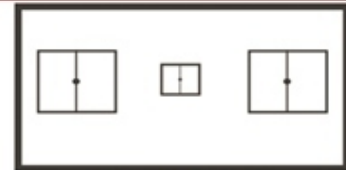

Back View

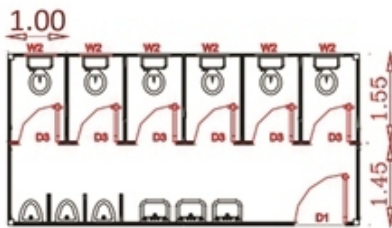

3x6 m Caravan - 6 bathrooms



Front View

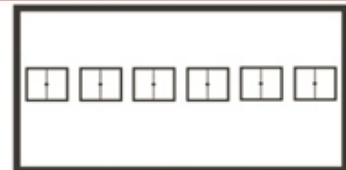

Back View

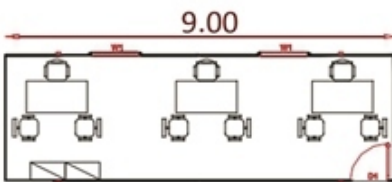

3x9 m Caravan - one room



Front View



Back View

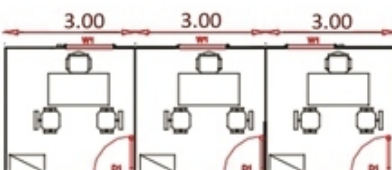

3x9 m Caravan - two room

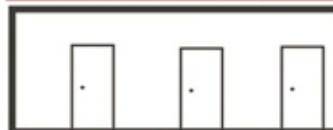

Front View

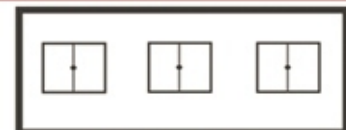

Back View



STANDARD MODULAR CARAVAN

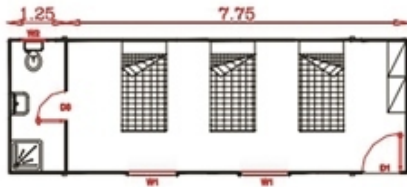

3×9 m Caravan - One Room & Bathroom

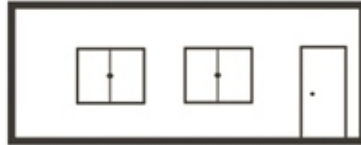

Front View



Back View

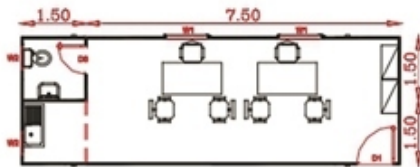

3×9 m Caravan - One Room , Bathroom & Kitchen



Front View

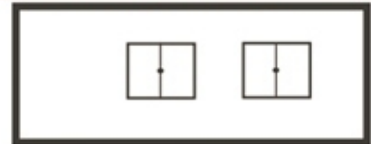

Back View

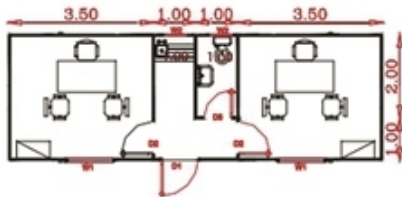

3×9 m Caravan - Two Room , Bathroom & Kitchen



Front View

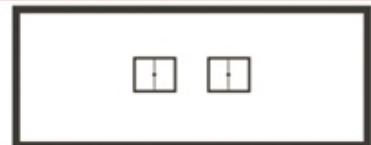

Back View

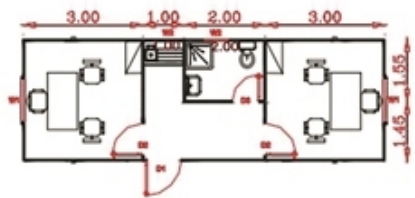

3×9 m Caravan - Two Room , Bathroom & Kitchen



Front View

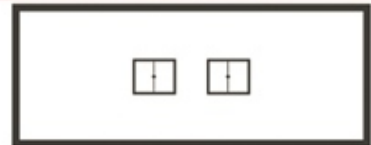

Back View

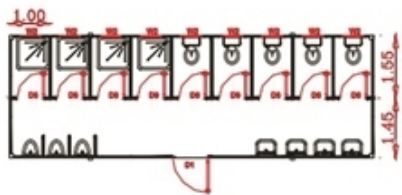

3×9 m Caravan - 9 Bathroom

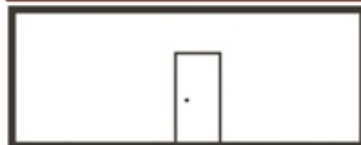

Front View



Back View



STANDARD MODULAR CARAVAN

3x12 m Caravan - 3 Rooms, Bathroom & Kitchen

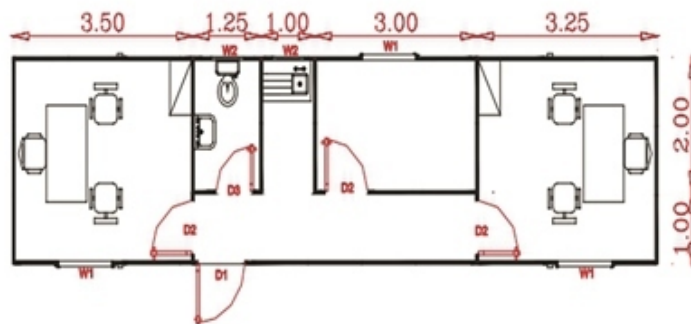

Front View

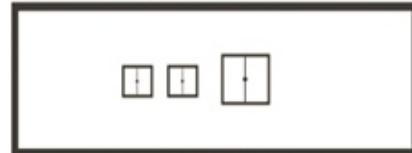

Back View

3x12 m Caravan - 2 Rooms & 2 Bathroom

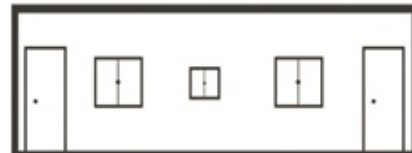
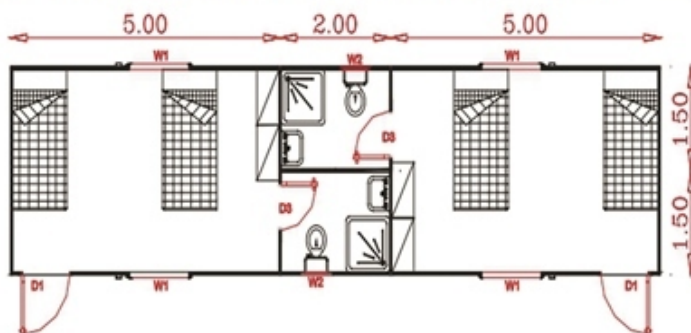

Front View

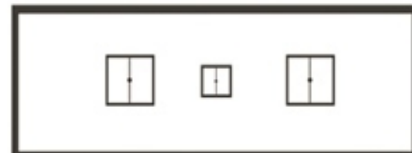

Back View

3x12m Caravan - 3 Rooms , Bathroom & Kitchen

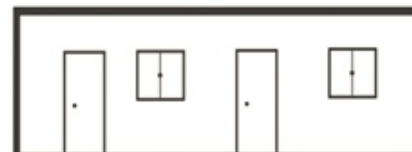
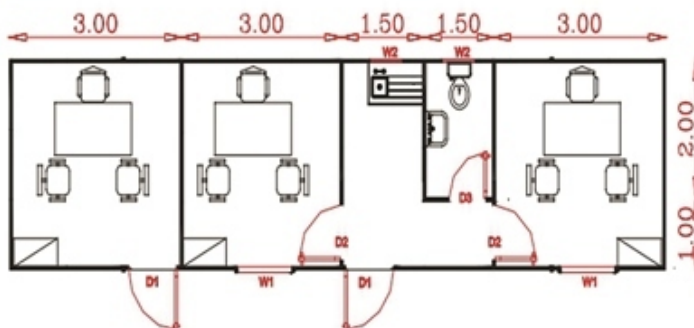

Front View

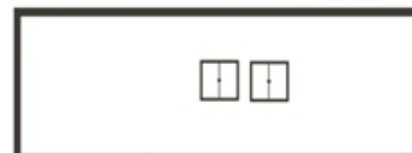

Back View



STANDARD MODULAR CARAVAN

3x12 m Caravan - One Room

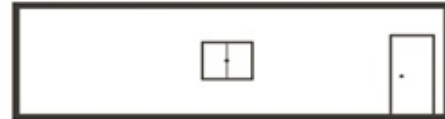
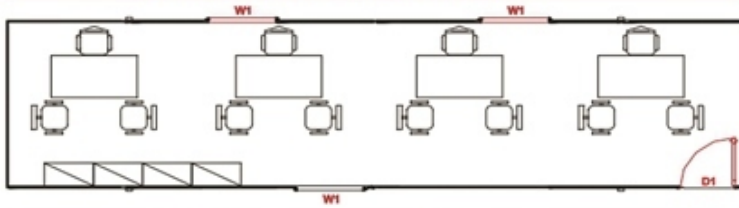

Front View



Back View

3x12 m Caravan - 4 Rooms

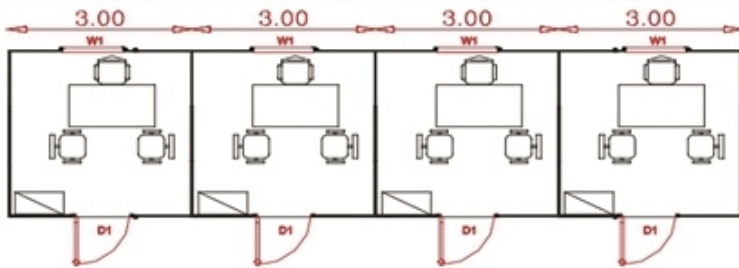

Front View



Back View

3x12 m Caravan - 2 Rooms , Bathroom & Kitchen

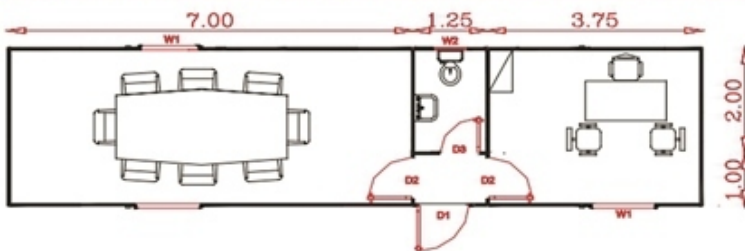

Front View



Back View

3x12m Caravan - 2 Rooms , Bathroom & Kitchen

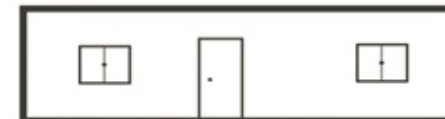
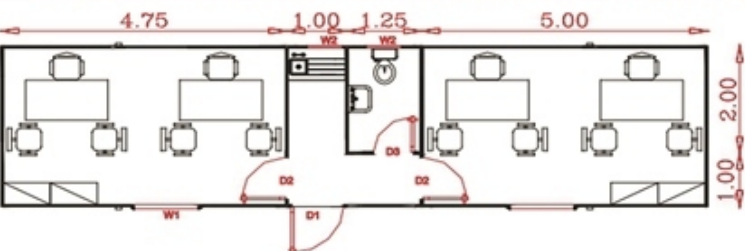

Front View

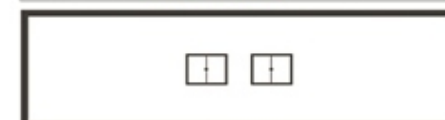

Back View

ISO - THERMAL INSULATED



HINGED DOORS

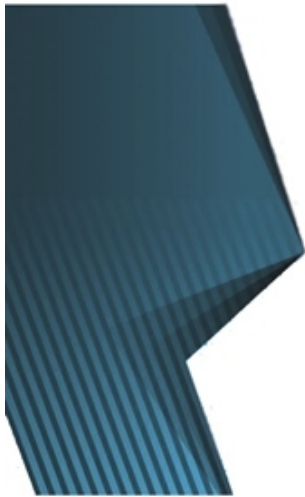

1

HINGED SINGLE LEAF DOOR

MAXIMUM DIMENSION IS 1500×2500mm . COMPOSED OF FOUR MAIN PARTS AS FOLLOWING

1 LEAF SPECIFICATIONS

- Leaf made up of two pre-painted hot dip - galvanized Steel Sheets Thickness 0.05mm (Standard), Thicker sheets available (on request), standard sheets color Ral 9016
- Leaf is surrounded by anodized aluminium profile
- Leaf is injected with polyurethane rigid Foam (PUR) materials in order to act the thermal insulation with density 40kg /m3 (+ 2kg)
- Along the edge of the anodized aluminum profile inserted a special EPDM rubber gasket double density in order to avoid leakage (temperature Seal) in deep freezers up to - 40 degrees inserted two double density gaskets
- Special 3 liens EPDM rubber gasket is fixed at the bottom of the door leaf (temperature seal floorless rooms)



Rail Passage

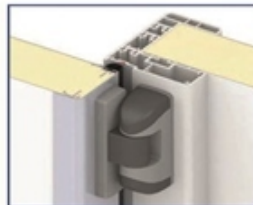

Connecting Door to the Frame

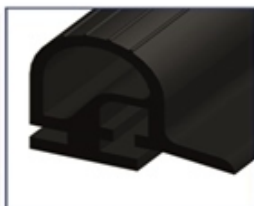

Gasket for BT Models

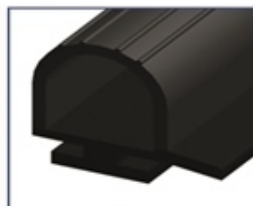

Gasket for TN Models





2 FRAME SPECIFICATIONS

A - Frame is made up from extruded P.V.C profiles reinforced internally by Steel and it is thermo - welded at (°45) delivered in 3 main parts :

- * Outside part two types one to be used for positive temperature and another for negative temperature
- * Side part : two sizes 30 and 50 mm to be connected to outside part in order to allow fixing on different Thicknesses
- * Counter frame : L shape fixed inside of the cold rooms

B - P.V.C Frames can be fixed either on panel with different thicknesses up to 200 mm or brick wall

C - Optional / Frame can be covered by welded stainless Steel 304 along with door leaf made both Sides from Stainless steel

D - For negative temperature a heating cable 40 w/m powered at 220 V is inserted inside the frame covered by aluminum profile

E - For deep freezers up to -40° heating cable 40 w/m powered at 220 V is inserted in both leaf and frame





F - Inside meet Processing Plants where there is a rail passage for meat moving from storage to operation area a special opening for rail is done as following :

- * The opening size will be 200 × 400 mm or as customer request
- * The opening will be surrounded by the P.V.C counter frame
- * Two rubber Seals will be fixed on the opening to let pass Guide Way



3 THRESHOLD

Four types of threshold are available depend on door application and temperature of room

A 1	A 2	A 3	A 4
<p>Frame is only 3 Parts without threshold connected to it for positive and negative temperature for negative temperature heating cable will be inserted inside a special rupper gasket profile or the P.V.C frame</p>	<p>Frame is only 3 parts and a 50x50 mm per-painted steel angle is connected to the frame at the bottom and recessed into the concrete floor, can be used for both positive and negative temperature for negative temperature heating cable will be inserted inside a special rubber gasket profile or inside the P.V.C frame</p>	<p>Frame is only 3 parts A metal tube angle 40x40mm joined with another stainless steel tube (20x40 mm) both are connected to the frame at the bottom and recessed into the concrete floor . A heating cable 40w/m powered at 220V is inserted inside the upper stainless-steel tube which remain visible at the same floor level only for negative temperature</p>	<p>Frame is 4 parts of P.V.C consist of (2jams+2 transoms) for both positive and negative temperature</p>
			

4 HARDWAER

The hinged system consists of the following parts

- 1- External fastener with key lock and emergency safety rel
- 2- Hinges

HINGED SYSTEM TECHNICAL DATA

- High quality italian hinged hardware
- All models are CE certified and tested up to 1000 times
- In ccompliance with EN179 rules
- Interchangeable right or left
- Inside emergency safety release push button
- Adjustments : horizontal / dual vertical adjustment
- Snatch- proof pin and temper - proof fixing at closed door
- Recessed auto - lubricating ramp
- Modular shims
- European standard compliant cylinder (Master key on request)

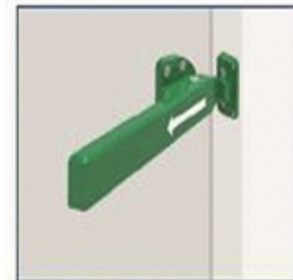

HINGED SINGLE LEAF MODELS

	M-70TN	M-100TN	M-70TNG	M-100TNG
Leaf Thickness	70mm	100mm	70mm	100mm
Temperature	+5°C	+2°C	+5°C	+2°C
Threshold	A1/A2/A4	A1/A2/A4	A1/A2/A4	A1/A2/A4
Rail Passage	—	—	Yes	Yes



M-70TN



M-100TN



M-100TNG

	M-100BT	M-120BT	M-150BT
Leaf Thickness	100mm	120mm	150mm
Temperature	-18°C	-30°C	-40°C
Threshold	A3/A4	A3/A4	A3/A4
Rail Passage	—	—	—



M-100BT



M-120BT



M-150BT



Elmazoor

Steel

Factories

- Factory 1 :Qalama
Egypt - Alexandria agricultural road , 20 km
- Factory 2 : Qalama
Egypt - Alexandria agricultural road , 19 km
- Factory 3 : Kafr abu gomaa
Egypt - Alexandria agricultural road , 18 km
- Factory 4 : Abu Sunna : slow way .Abu Sunna
main street In front of Abu Sunna Post Office
- Factory 5 : Meet nama . Ezbet Ayrout
next to Ahmed Saeed Refrigerator
Basos. alqanatir alkhayrih .Qalyubia
- Factory 6 : 10th of ramadan - industrial zone A/1 area 5/6
- Factory 7 : 10th of ramadan - industrial zone A/5 area 204
- Factory 8 : Zone 146 - ataqa suez

Tel : 01110107871 - 01154040111 - 01100943504 - 01159898501
01110107876 - 01016969833 - 01000525353 - 01211122580

Branches

- NO. 125 Sabtiyah street - bulaq
- NO. 3 Masaken street - sabtiyah
souq elasn
- NO. 78 Sidi said - alsabtiyah square
- Qalioub - meet halfa - the slow road
- Qalyub : The slow way
In front Eltemsah scale
- H.office: villa754 elsheikh zayed
hadayek elmohandeseen
compound

www.elmazoorsteel.com



Elmazoor Steel



Elmazoor_Steel

